

St. Mary Medical Center



ST. JOSEPH HEALTH SYSTEM

A Ministry of the **Sisters of St. Joseph** of Orange
and the **Brothers of St. John of God**

18300 HIGHWAY 18 APPLE VALLEY CALIFORNIA 92307
760 242-2311

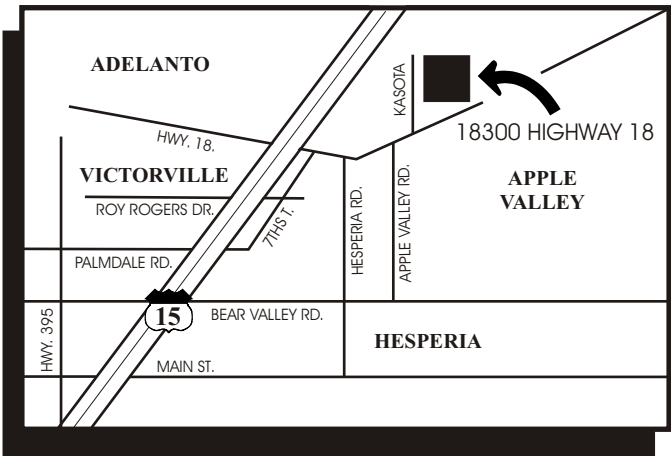

HELIPORT

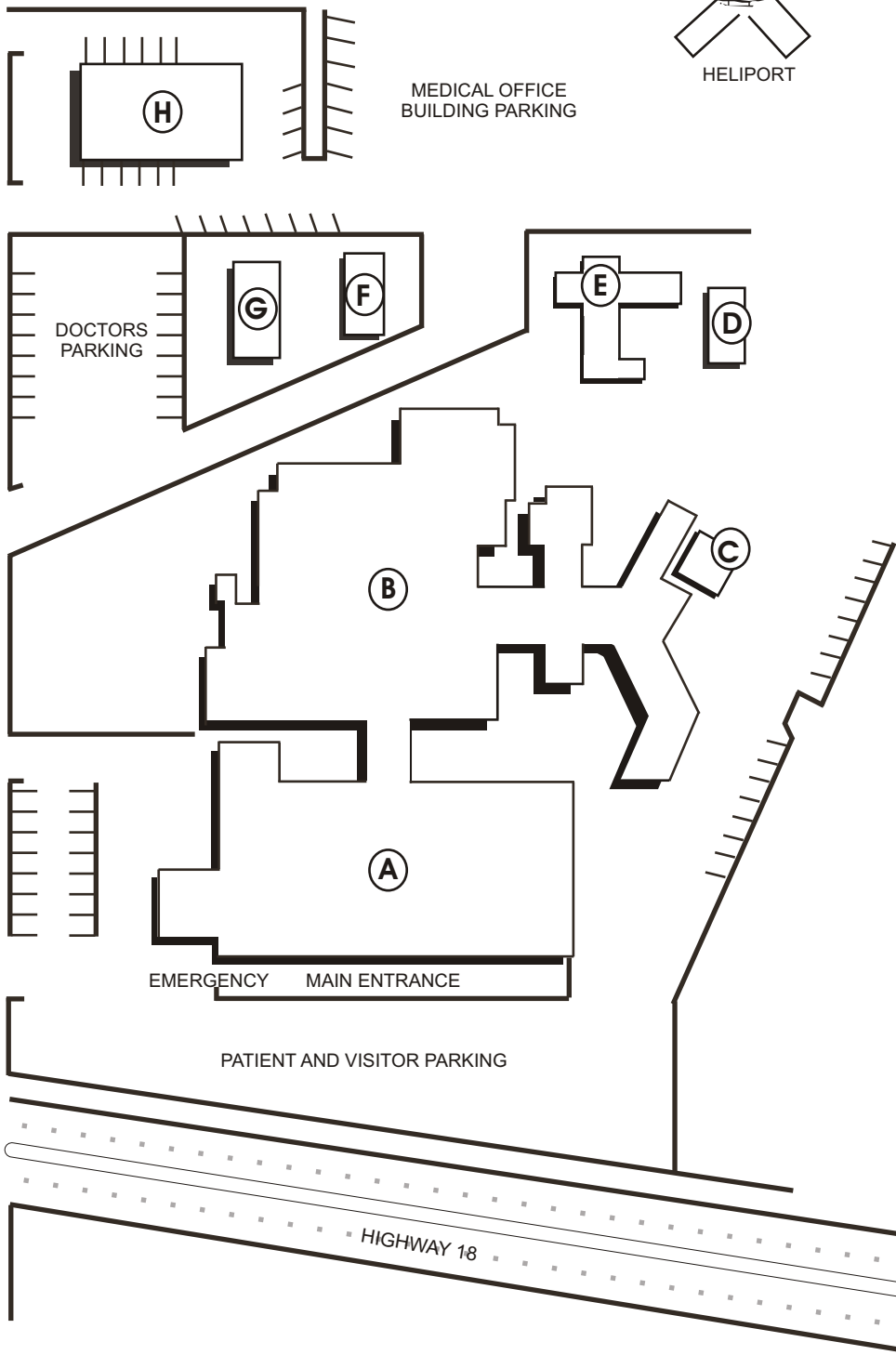

LEGEND

- A FIRST FLOOR**
- B SECOND FLOOR**
- C HUMAN RESOURCES**
- D MRI**
- E ANNEX BUILDING**
Brothers Conf. Room; Mtg. Rooms
A, B, & C; Spiritual Care
and Foundation.
- F MARKETING, PUBLIC
RELATIONS, COMMUNICATION**
- G CENTER FOR LEARNING &
CURRICULUM, RISK, I.S.**
- H MEDICAL OFFICE BUILDING**
Outpatient Rehabilitation Services,
Outpatient Laboratory, Classroom
200, Cardiac Physicians
- I BUSINESS OFFICE**
- J MATERIALS MANAGEMENT**



EMPLOYEE
PARKING

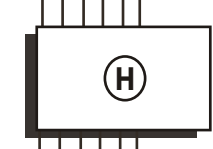

MEDICAL OFFICE
BUILDING PARKING

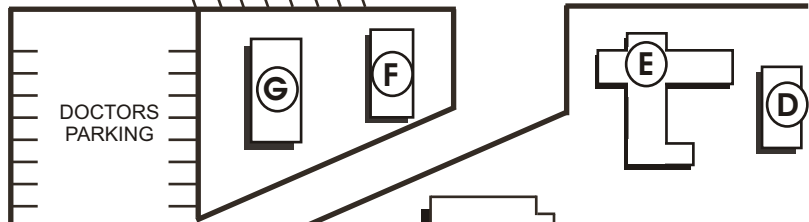

DOCTORS
PARKING

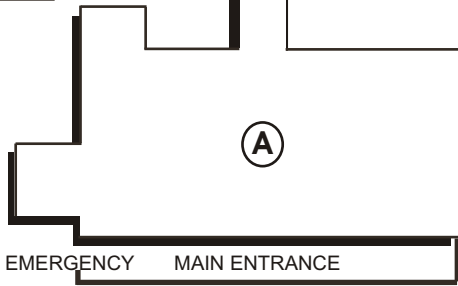

EMERGENCY MAIN ENTRANCE

PATIENT AND VISITOR PARKING

HIGHWAY 18

KASOTA ROAD